

Page 133
Charles Dunn

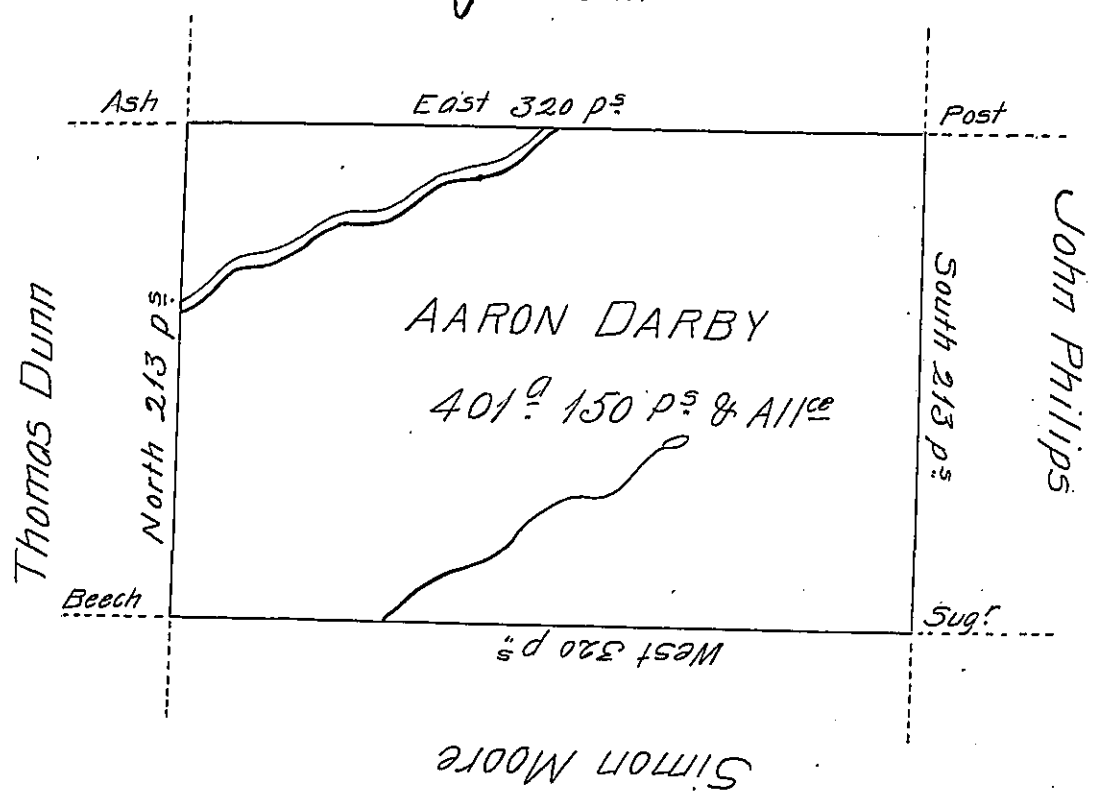

Situate on the west side of French Creek in Allegheny County. Containing
401 Acres and 150 p.s. and Allowance of six per Cent for Roads & a
Surveyed the 7th day of October 1794 In pursuance of a warrant dated the
10th day of April 1793.

W^m Power D.Y.S.

To Daniel Brodhead Esq.
Surveyor General

IN TESTIMONY that the above is a copy of the original remaining on file in
the Department of Internal Affairs of Pennsylvania, made
conformably to an Act of Assembly approved the 16th day of
February, 1833, I have hereunto set my Hand and caused
the Seal of said Department to be affixed at Harrisburg,
this twenty-first day of June 1904.

Isaac R. Brown
Secretary of Internal Affairs.